



Hunt Estates

An Elegant Six-Bedroom Victorian Villa With A Double Garage
St. Helier, Jersey

AN ELEGANT SIX-BEDROOM VICTORIAN VILLA WITH A DOUBLE GARAGE

This spacious and elegant Victorian villa is one of five within a terrace of similar fine properties in an elevated position set back from the road.

The property is light and airy with well-proportioned rooms, high ceilings and many of the internal features so typical of this bygone era.

This popular location lies within easy walking distance of the town centre and so many amenities including the local supermarket, primary school, Howard Davis Park, and the bathing pool at Havre des Pas. The range of nearby cafes, restaurants and pubs would leave you spoilt for choice.

There are six bedrooms and two bathrooms set on three floors with a formal garden to the front and a small, enclosed garden to the rear.

To the rear of the property accessed via a private lane, is a double garage with an additional area of parking to the front of the garage.

The property retains many of its original features and would benefit from some modernisation.

























FEATURES

- Mid terrace Victorian villa
- Six-bedroom, two bathrooms
- Elevated position set back from the road
- Outside space to front and back
- Elegant terrace of similar properties
- Close to the beach and park

INFORMATION

- All mains' services (excluding gas)
- Oil fired central heating (Ground & 1st floor)
- Heritage listed at Level 3
- Mainly single glazed
- Double garage and parking space for one car
- No onward chain
- Freehold and Entitled/Licensed
- Parish rates for 2023 were £703.36



David Voak
Property Negotiator

david@huntstates.com
T +44 (0)7797 725621
www.huntstates.com
9 New Street, St Helier,
Jersey, JE2 3RA

CHRISTIE'S | Hunt Estates
INTERNATIONAL REAL ESTATE

GROUND FLOOR
1285 sq.ft. (119.4 sq.m.) approx.

1ST FLOOR
664 sq.ft. (61.7 sq.m.) approx.

2ND FLOOR
446 sq.ft. (41.4 sq.m.) approx.

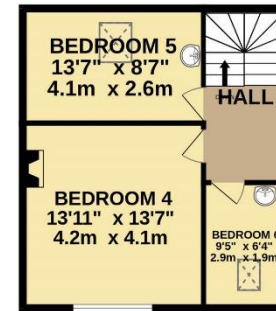

Hunt Estates

TOTAL FLOOR AREA : 2395 sq.ft. (222.5 sq.m.) approx.

Whilst every attempt has been made to ensure the accuracy of the floorplan contained here, measurements of doors, windows, rooms and any other items are approximate and no responsibility is taken for any error, omission or mis-statement. This plan is for illustrative purposes only and should be used as such by any prospective purchaser. The services, systems and appliances shown have not been tested and no guarantee as to their operability or efficiency can be given.

Made with Metropix ©2023

Hunt Estates

9 New Street, St Helier, Jersey, JE2 3RA, Channel Islands | +44 1534 860650 | www.huntestates.com | enquiries@huntestates.com

Disclaimer: All information provided herein has been obtained from sources believed reliable, but may be subject to errors, omissions, change of price, prior sale, withdrawal without notice. Hunt Estates make no representation, warranty, or guarantee as to accuracy of any information contained herein. You should consult your advisors for an independent investigation of any properties. All viewings to be conducted through Hunt Estates.