



Hunt Estates

Brand New Two Bedroom Apartment With Parking
St. Helier, Jersey

BRAND NEW TWO BEDROOM APARTMENT WITH PARKING

A brand new, purpose built, two-bedroom apartment in the South block of the Horizon development. The apartment is situated on the 2nd floor and has been finished in line with the silver specification. It benefits from views across St Helier town centre and partial sea views and of the marina from the balcony.

The apartment is a good size with approx. 715 sq. ft of accommodation and comprises; entrance hall, open plan modern kitchen/sitting area with floor to ceiling windows allowing lots of light to flood through the apartment and with access to a balcony, two double bedrooms, both with fitted wardrobes, house bathroom with double wash hand basins and a utility cupboard with space and plumbed for a washer/dryer.

The apartment has been fitted throughout with blinds.

The apartment benefits from one parking space in the secure underground parking area and has lift access.

The close proximity to St. Helier town centre, and with all the facilities at the Waterfront on hand, make this an ideal location for living and working in St. Helier.

Viewings are highly recommended.

















FEATURES

- Newly constructed Horizon apartment
- Purpose built second floor apartment
- Two double bedrooms, one bathroom
- Modern open plan sitting room/kitchen
- On site caretaker
- Balcony off sitting room

INFORMATION

- Mains water and drains
- Electric heating
- Triple glazing
- Lift access
- Concierge service and CCTV
- Colour video entry door system
- Secure underground parking for one car
- Monthly service charge of £323.60 per month to cover parish rates, water rates and service charge
- Share transfer



Gill Hunt, FNAEA
Director

gill@huntstates.com
T +44 (0)7797 721881
www.huntstates.com
9 New Street, St Helier,
Jersey, JE2 3RA

CHRISTIE'S | Hunt Estates
INTERNATIONAL REAL ESTATE



s 2 1 1

SECOND

s 4 1 1

FOURTH

s 6 1 1

SIXTH

2 0

▲ Floor

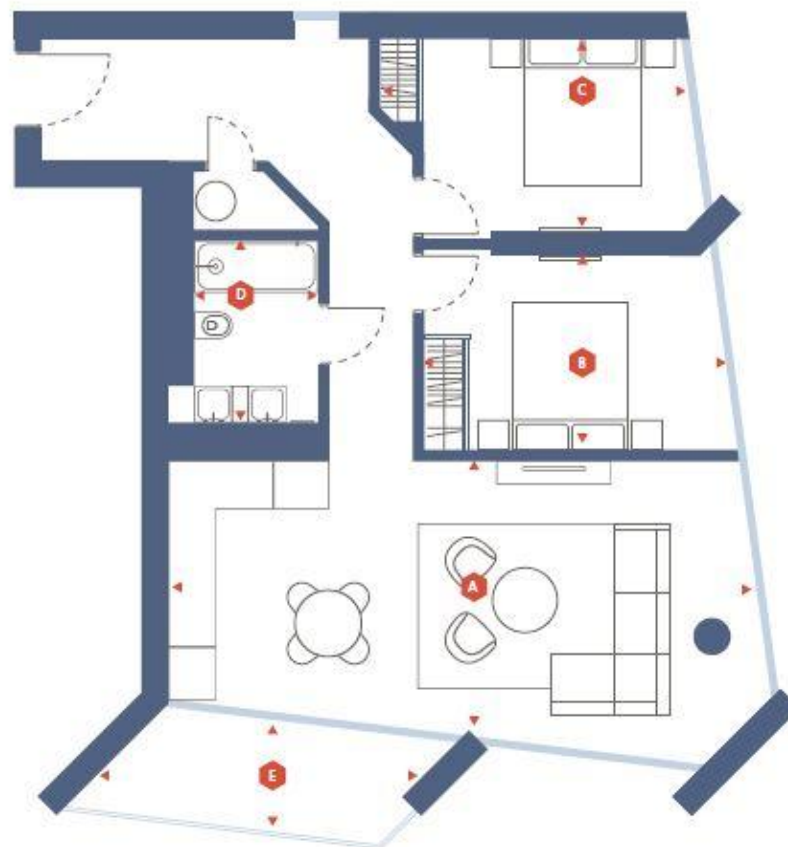

▼ Gross Internal Area

66.42 m² / 714.68 ft²

▼ External Dimensions

5.91 m² / 63.61 ft²

▼ Approximate Room Dimensions

A - W: 3.48 m / 11.4 ft X L: 7.6 m / 24 ft

B - W: 3.75 m / 12.3 ft X L: 2.59 m / 8.5 ft

C - W: 3.93 m / 12.9 ft X L: 2.58 m / 8.5 ft

D - W: 1.7 m / 5.6 ft X L: 2.4 m / 7.9 ft

E - W: 1.8 m / 5.9 ft X L: 4.11 m / 13.5 ft

▼ Locator



N

Hunt Estates

9 New Street, St Helier, Jersey, JE2 3RA, Channel Islands | +44 1534 860650 | www.huntestates.com | enquiries@huntestates.com

Disclaimer: All information provided herein has been obtained from sources believed reliable, but may be subject to errors, omissions, change of price, prior sale, withdrawal without notice. Hunt Estates make no representation, warranty, or guarantee as to accuracy of any information contained herein. You should consult your advisors for an independent investigation of any properties. All viewings to be conducted through Hunt Estates.