



CHRISTIE'S
INTERNATIONAL REAL ESTATE

Hunt Estates

CHRISTIE'S | Hunt Estates
INTERNATIONAL REAL ESTATE

Family home overlooking St Brelade's Bay
St Brelade, Jersey

FAMILY HOME OVERLOOKING ST BRELADE'S BAY

An attractive detached house located at the end of a private close with no through traffic, with lovely south facing sea views.

Conveniently located just a short drive from St Brelade's Bay with restaurants and cafes. Also close to hand are golf courses, sports centre, supermarkets, chemist, and doctor's surgery.

Ground floor comprising: entrance porch, entrance hall, cloak room, sitting room, dining room, study/TV room, kitchen with space for a breakfast table, utility room and rear porch.

First floor comprising; four bedrooms, one en suite bathroom and family bathroom. There is a balcony overlooking the garden and sea, accessed from the first floor landing.

The property has a light and airy feel throughout. There is further scope to enhance the property. Of particular note is the large attic space which could become further living/bedroom accommodation with sea views (subject to planning permission).

Externally there is a lawned south facing garden and heated swimming pool with patio surround.







CHRISTMAS
INTERNATIONAL REAL ESTATE





CHRISTIE'S

INTERNATIONAL REAL ESTATE

Hunt Estates







FEATURES

- 4-bedroom family home
- 3 reception rooms
- Over 3,000 sq ft
- Close to local amenities and St Brelade's Bay
- Beautiful sea views
- Heated swimming pool
- Large attic which could provide further accommodation (subject to planning permission)

INFORMATION

- Mains water and drains
- Oil fired central heating
- All double glazed (except house bathroom window)
- Single garage and parking for up to 4 cars (tandem)
- Freehold and Entitled



Gill Hunt, FNAEA
Director

gill@huntestates.com
T +44 (0)7797 721881
www.huntestates.com
9 New Street, St Helier,
Jersey, JE2 3RA

CHRISTIE'S | Hunt Estates
INTERNATIONAL REAL ESTATE

GROSS INTERNAL AREA
 FLOOR 1: 1452 sq. ft, FLOOR 2: 1104 sq. ft
 FLOOR 3: 522 sq. ft,
 TOTAL: 3079 sq. ft

EXCLUDED AREAS:
 REDUCED HEADROOM BELOW 1.5M: 558 sq. ft,
 GARAGE: 174 sq. ft, POOL CHANGING ROOM: 31 sq. ft

SIZES AND DIMENSIONS ARE APPROXIMATE, ACTUAL MAY VARY

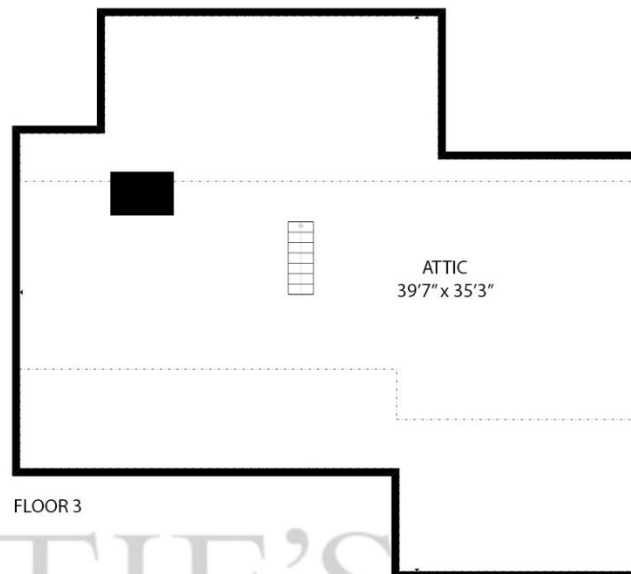

FLOOR 3



FLOOR 1



FLOOR 2

CHRISTIE'S
 INTERNATIONAL REAL ESTATE
 Home Estates

As the selected exclusive affiliate of Christie's International Real Estate in Jersey, Channel Islands, Hunt Estates combines local expertise with global reach via Christie's affiliation to the most famous real estate companies in the world.

An invitation-only affiliate network, Christie's International Real Estate selected Hunt Estates in 2020 to represent the famous Christie's brand in the sphere of luxury real estate in Jersey.

CHRISTIE'S | Hunt Estates

INTERNATIONAL REAL ESTATE

9 New Street, St Helier, Jersey, JE2 3RA, Channel Islands | +44 1534 860650 | www.huntestates.com | enquiries@huntestates.com

Disclaimer: All information provided herein has been obtained from sources believed reliable, but may be subject to errors, omissions, change of price, prior sale, withdrawal without notice. Hunt Estates make no representation, warranty, or guarantee as to accuracy of any information contained herein. You should consult your advisors for an independent investigation of any properties. All viewings to be conducted through Hunt Estates.