



Hunt Estates

One Bedroom Horizon Apartment with Views Across St Helier  
St. Helier, Jersey



## ONE BEDROOM HORIZON APARTMENT WITH VIEWS ACROSS ST HELIER

A one-bedroom apartment in the East building of the brand-new Horizon development. It is situated on the 6<sup>th</sup> floor and has been finished to a high standard throughout.

Comprising; open plan modern kitchen/sitting area with floor to ceiling windows allowing lots of light to flow through the apartment. There are sliding doors that open out onto a good-sized balcony, which enjoys views across St Helier town centre.

There is one double bedroom with fitted wardrobes, a house bathroom and a utility cupboard with space and plumbed for a washer/dryer.

The close proximity to St Helier town centre, and with all the facilities at the Waterfront on hand, makes this an ideal location for living and working in St Helier.

This lovely one-bedroom apartment would make an ideal starter home or buy to let.

Highly recommended for viewings by the vendors sole agent.





Hunt Estates



















## FEATURES

- Brand new one bedroom apartment
- Modern open plan sitting room/kitchen
- Good sized balcony with views across St Helier
- Close to St Helier town centre
- Ideal starter home or buy to let
- Two minute walk to the marina and Waterfront gardens

## INFORMATION

- Mains water and drains
- Electric heating
- Comfort cooling and heating system to kitchen, living room and bedrooms.
- Lift service
- Concierge service and CCTV
- Colour video entry door system
- Monthly service charge of approx. £221 to cover parish occupier and foncier rates, water rates and service charge
- Share transfer



Gill Hunt, FNAEA  
Director

[gill@huntstates.com](mailto:gill@huntstates.com)  
T +44 (0)7797 721881  
[www.huntstates.com](http://www.huntstates.com)  
9 New Street, St Helier,  
Jersey, JE2 3RA

CHRISTIE'S | Hunt Estates  
INTERNATIONAL REAL ESTATE

Two minute walk to the marina



Two minute walk to Waterfront Gardens





▼ Apartment numbers

E 2 0 3 | E 4 0 3 | E 6 0 3 | E 8 0 3  
SECOND | FOURTH | SIXTH | EIGHTH

▼ Type

0 3 A

▲ Floor

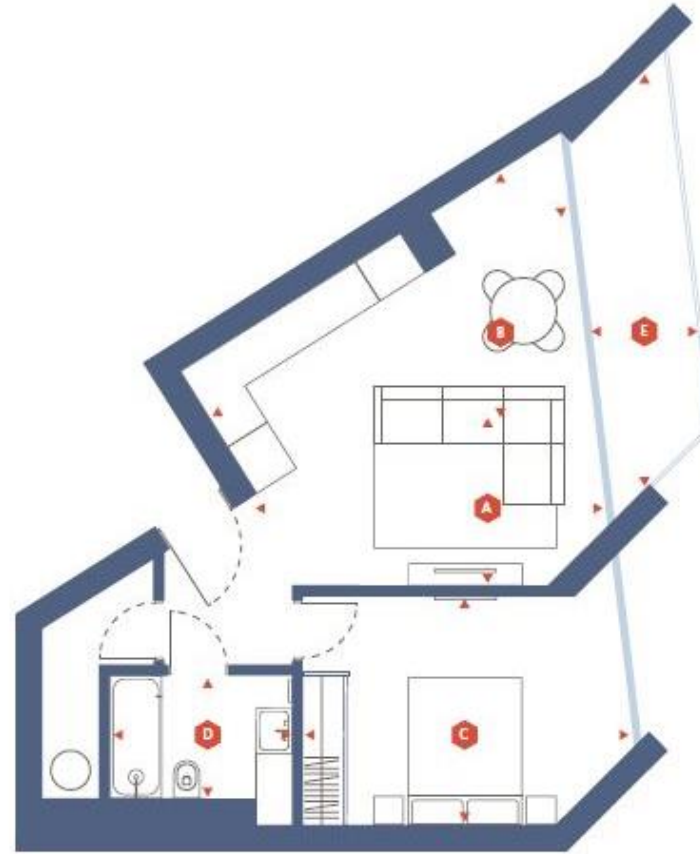

▼ Gross Internal Area

47.09m<sup>2</sup> / 506.69 ft<sup>2</sup>

▼ External Dimensions

7.18m<sup>2</sup> / 77.2 ft<sup>2</sup>

▼ Approximate Room Dimensions

A - W: 4.71 m / 15.5 ft X L: 2.0 m / 6.5 ft  
B - W: 3.5 m / 11.5 ft X L: 3.6 m / 11.8 ft  
C - W: 4.33 m / 14.2 ft X L: 3.03 m / 10 ft  
D - W: 2.43 m / 8 ft X L: 1.7 m / 5.5 ft  
E - W: 1.5 m / 4.9 ft X L: 3.2 m / 10.5 ft

▼ Locator

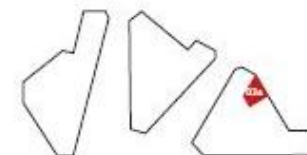

120

# Hunt Estates

9 New Street, St Helier, Jersey, JE2 3RA, Channel Islands | +44 1534 860650 | [www.huntestates.com](http://www.huntestates.com) | [enquiries@huntestates.com](mailto:enquiries@huntestates.com)

Disclaimer: All information provided herein has been obtained from sources believed reliable, but may be subject to errors, omissions, change of price, prior sale, withdrawal without notice. Hunt Estates make no representation, warranty, or guarantee as to accuracy of any information contained herein. You should consult your advisors for an independent investigation of any properties. All viewings to be conducted through Hunt Estates.