



Hunt | Estates

Trinity
£899,000

Family home with sea views

This charming four bedroom family home is situated in a development on the north coast.

Just moments from the stunning north coast cliff paths, Bouley Bay and Rozel Harbour are close at hand, ideal for weekend breakfasts and walks with the family.

Whilst being surrounded by countryside, you are not far from the zoo at Durrell and the main access routes into St Helier.



Hunt | Estates

Sacha Butlin
Negotiator

sacha@huntstates.com
T +44 (0)7829 917449
www.huntstates.com
9 New Street, St Helier, Jersey, JE2 3RA







This property is located in an attractive granite development with uninterrupted views of the sea.

Spread over 3 floors, and offering over 2,100 sq ft of accommodation, this home has generous sized bedrooms, 2 of which are en suite. The master bedroom also benefits from a sea facing balcony, perfect for your morning coffee.

In addition to the balcony, there is an enclosed garden with a patio area.



Comprising Entrance hall, spacious eat-in kitchen, sitting room with access to garden, cloakroom.

On the first floor is a large master bedroom with en suite and balcony overlooking the sea, double bedroom with en suite, and a further two bedrooms and house bathroom on the top floor.



FEATURES

Four bedrooms, 2 en suite
Large sitting room
Enclosed garden with patio area
First floor balcony with sea views
Single garage and parking for 2 cars
Close to Rozel Harbour
Beautiful coastal location

SERVICES

Septic tank
Borehole water with UV filtration system
Gas central heating
Double glazed

PARKING

Single garage
Parking for two cars
5 x communal parking spaces

CATEGORY AND TENURE

Entitled and Freehold





GROUND FLOOR
770 sq.ft. (71.6 sq.m.) approx.

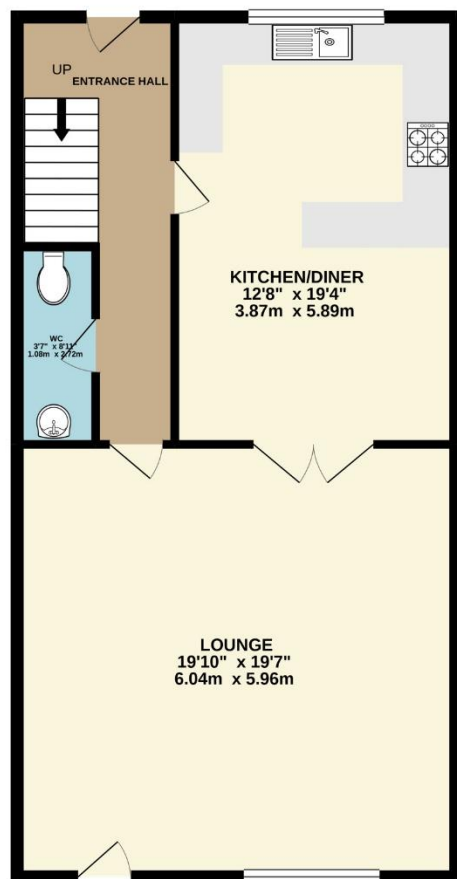

1ST FLOOR
683 sq.ft. (63.4 sq.m.) approx.

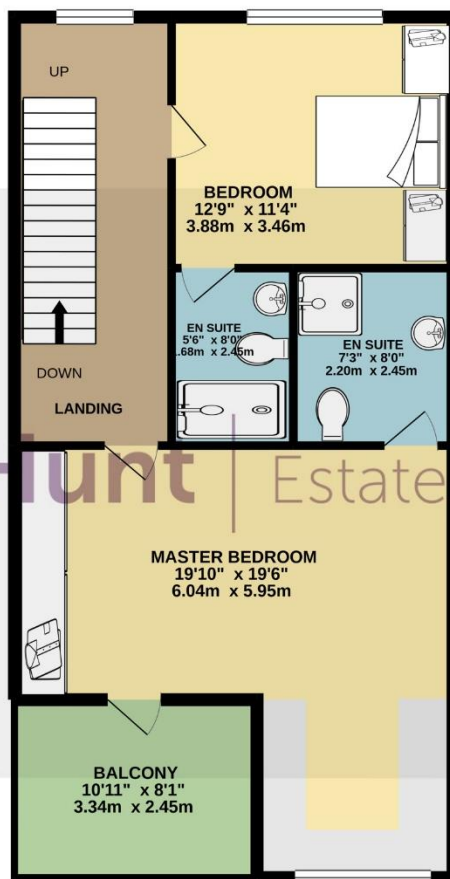

2ND FLOOR
683 sq.ft. (63.5 sq.m.) approx.

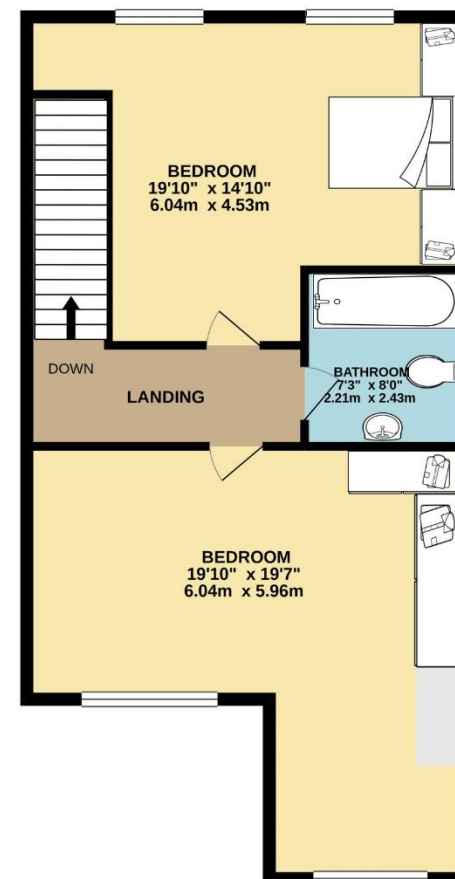

TOTAL FLOOR AREA : 2136 sq.ft. (198.5 sq.m.) approx.

Whilst every attempt has been made to ensure the accuracy of the floorplan contained here, measurements of doors, windows, rooms and any other items are approximate and no responsibility is taken for any error, omission or mis-statement. This plan is for illustrative purposes only and should be used as such by any prospective purchaser. The services, systems and appliances shown have not been tested and no guarantee as to their operability or efficiency can be given.
Made with Metropix ©2020

Disclaimer: The agent has not tested any apparatus, equipment, fixtures and fittings or services and so cannot verify that they are in working order or fit for purpose. A buyer is advised to obtain verification from their advocate or surveyor. References to the tenure of a property are based on information supplied by the seller. The agent has not had sight of the title documents. A buyer is advised to obtain verification from their advocate. Items shown in photographs are not included unless specifically mentioned within the sales particulars. They may however be available by separate negotiation. An inventory of the contents to be included in the transaction, will be compiled once the sale is agreed. Buyers must check the availability of any property and make an appointment to view before embarking on any journey to see a property. All measurements are approximate.

All viewings to be conducted through Hunt Estates. Tel: 01534 860650